

MAIN DECK

1 / 8"

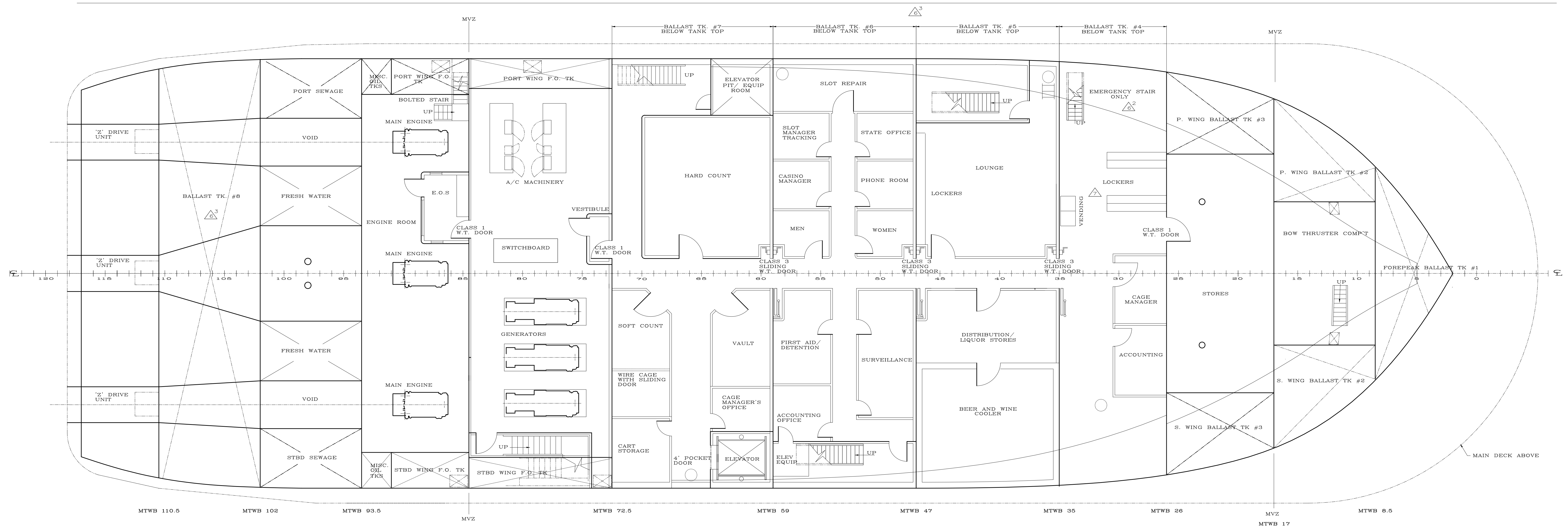

LOWER DECK

1 / 8"

REFERENCES				REVISIONS			
NO.	DRAWING TITLE	DWG. NO.	BY	NO.	DESCRIPTION	DATE	BY
1.	2ND AND 3RD DECK ARRANGEMENTS	2996-A12	REL&A	1.	REVISED PER 6/21/93 MEETING COMMENTS	7-8-93	SMW
2.	4TH AND PILOT HOUSE DECK ARRANGEMENTS	2996-A13	REL&A	2.	REVISED PER MEETING COMMENTS	7-30-93	RAW
3.	OUTBOARD PROFILE	2996-A19	REL&A	3.	GENERAL REVISIONS	8-3-93	FSS
				4.	GENERAL REVISIONS	9-2-93	FSS
				5.	SEE REVISION LETTER DATED 12-14-93	12-14-93	JJM
				6.	SEE REVISION LETTER DATED 2-8-94	2-8-94	JJM
				7.	GAMING REVISIONS, ADD BANKS, LKRS, VEND'G	4-20-95	SMW

RODNEY E. LAY & ASSOCIATES
 NAVAL ARCHITECTS
 13891 ATLANTIC BOULEVARD, JACKSONVILLE, FLORIDA 32225

This design, including specifications, drawings and its contents, are the exclusive property of Rodney E. Lay & Associates, and is furnished on a confidential basis with the expressed agreement that it will not be used, reproduced, copied, photographed or recorded in any manner whatsoever in whole or in part, nor any item herein be built, manufactured, tested, photographed or reproduced in any manner without the written agreement of Rodney E. Lay & Associates. The recipient agrees not to disclose to any other party information herein, nor to use such information except for the specific purpose contracted for.

240' X 77' CASINO VESSEL FOR ARGOSY - RIVERSIDE
LOWER & MAIN DECK ARRANGEMENTS
 SCALE 1/8" = 1'-0" DATE 6-23-93 DRAWN BY MEP CDD REL DWG. NO. 2996-A11 REV. 7